

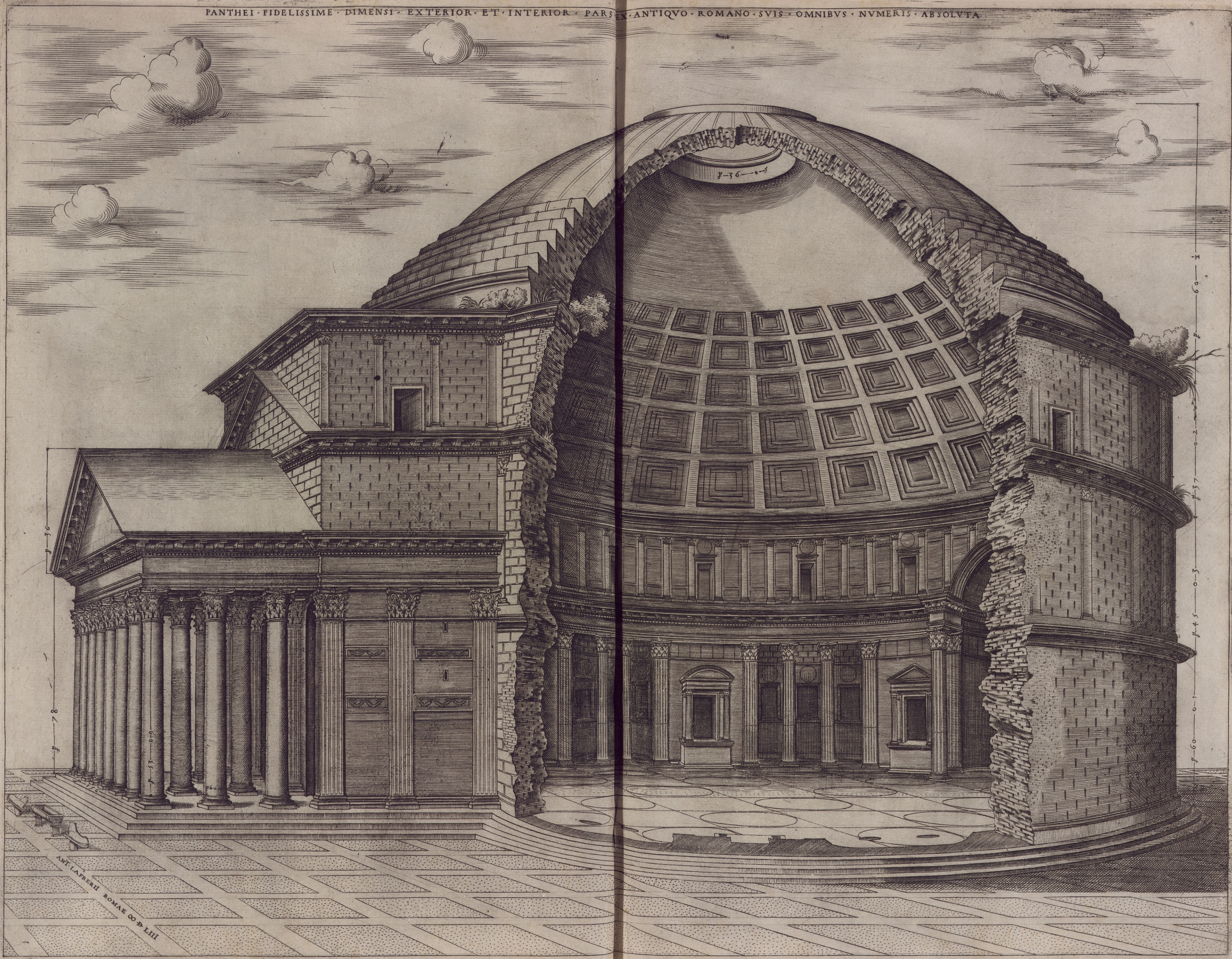

PANTHEI · FIDELISSIME · DIMENSI · EXTERIOR · ET · INTERIOR · PARS · EX · ANTIQVO · ROMANO · SVIS · OMNIBVS · NVMERIS · ABSOLVTA



8-36-0-3

8-36-0-3

8-60-0-1

ANT. LARRERI ROMAE MDCLIII







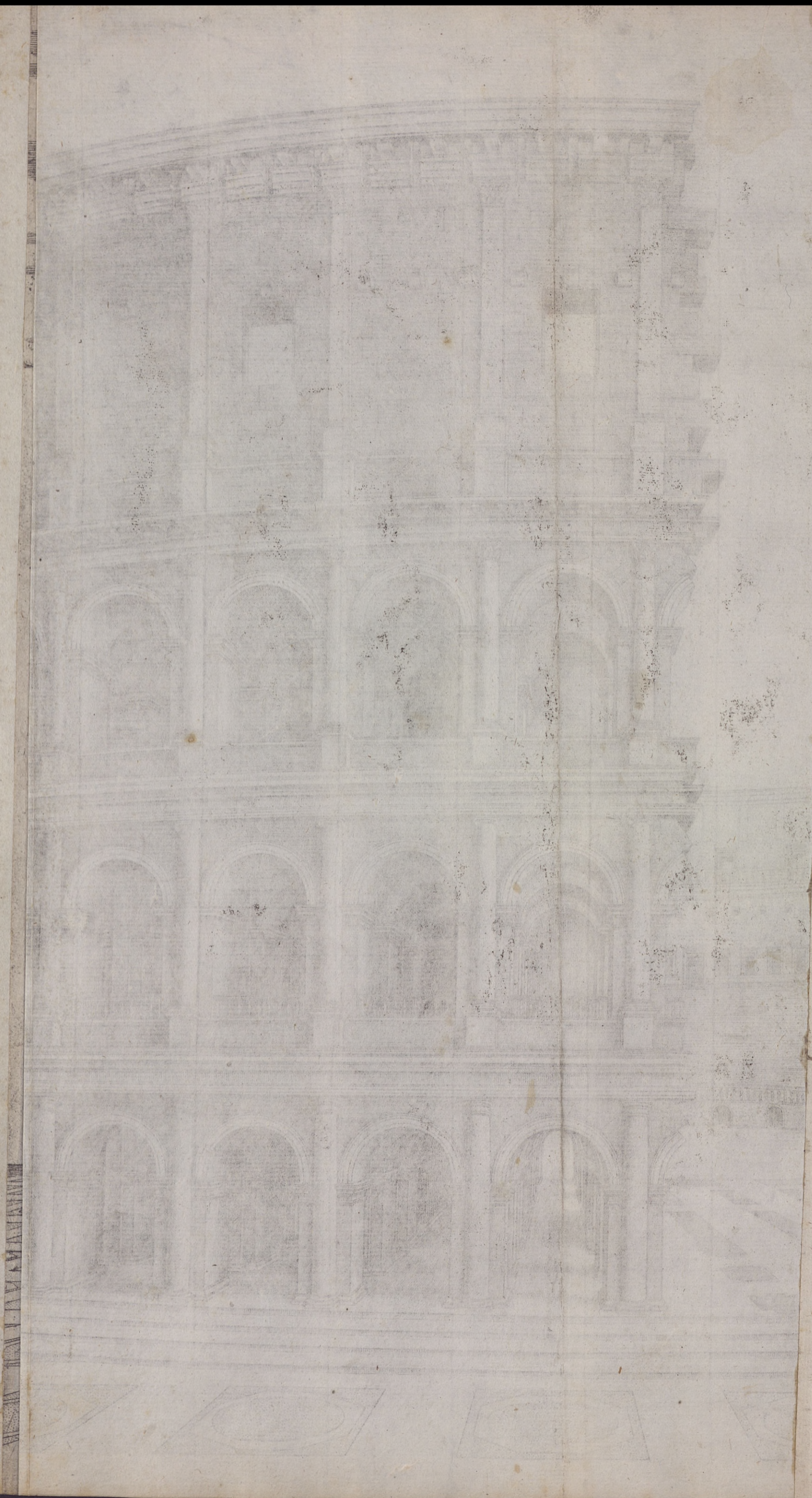





Ant. Sala.
Excudebat.

COM GRATIA
ET PRIVILEGIO

AEDIS D. PETRI. ORTHOGRAPHIA. EX IP SO. ANT. SAICTIGALLI. EXEMPLARI. ROMAE. MDCXLVIII.



PRINTED BY G. & J. S. SMITH, ST. MARTIN'S LANE, LONDON.

THE GREAT HALL OF THE UNIVERSITY OF OXFORD



FORMA TEMPLI D PETRI IN VATICANO



ANTONIUS S GALLI INVENTOR
ANTONIUS LABACCVS EIVS DISCIP
EFFECTOR

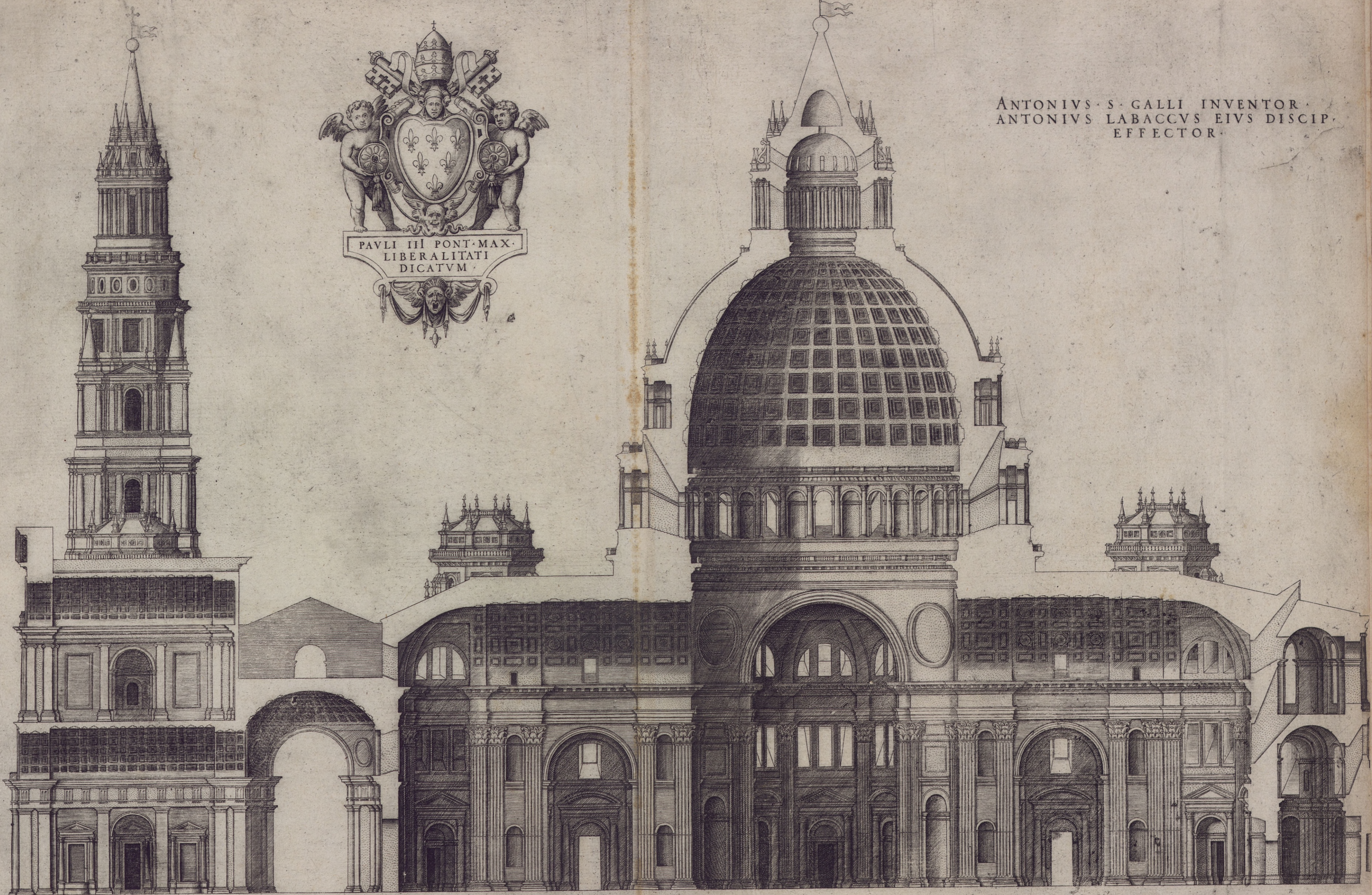

CVM GRATIA ET PRIVILEGIO

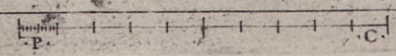

ANT-SAL-EX
ROM.6-50-D

ANTONIO M. VALLI INVENTOR

ANTONIO M. VALLI INVENTOR
ANTONIO M. VALLI INVENTOR
ANTONIO M. VALLI INVENTOR

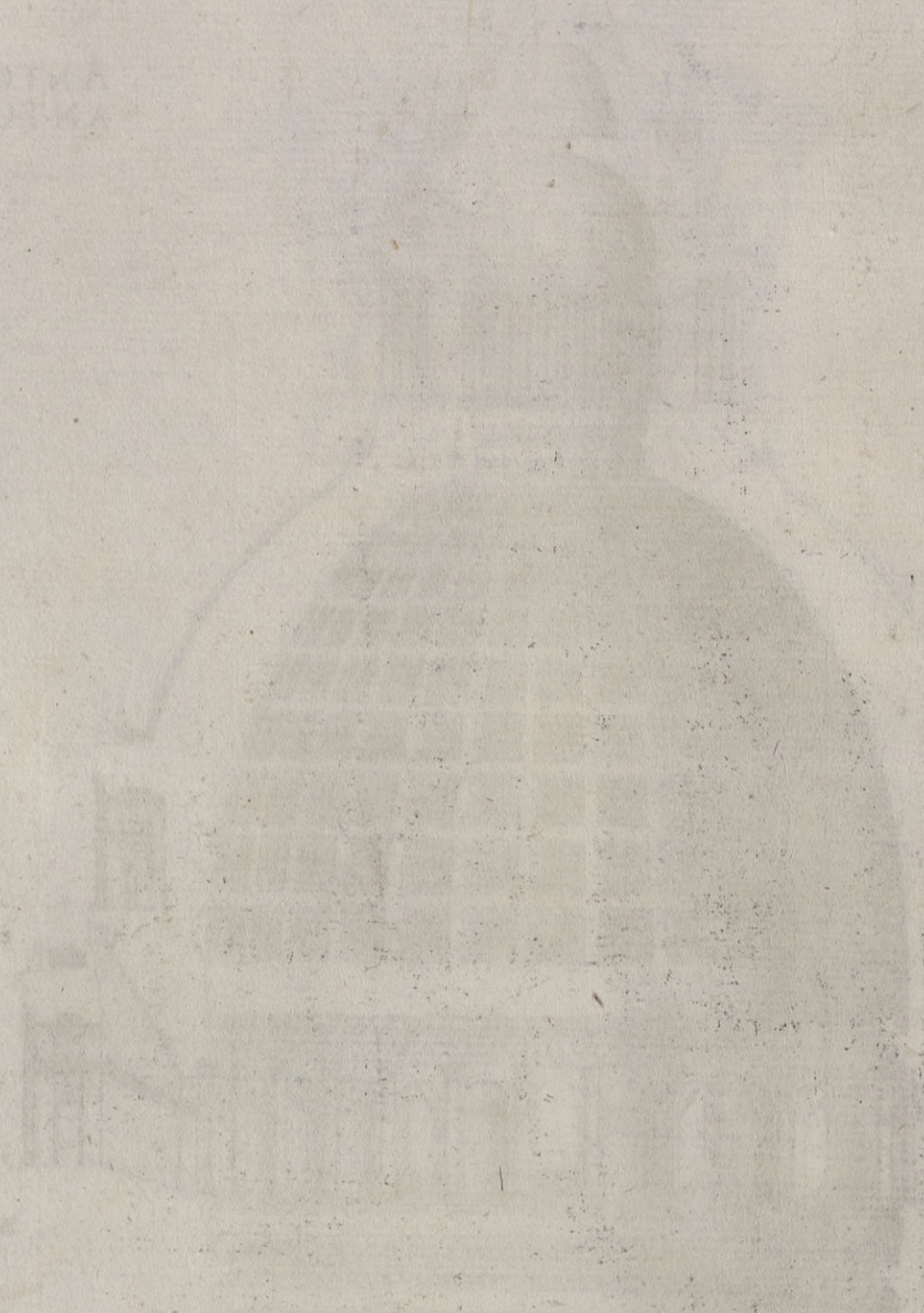

Faint, illegible text or markings at the bottom of the page, possibly bleed-through from the reverse side.

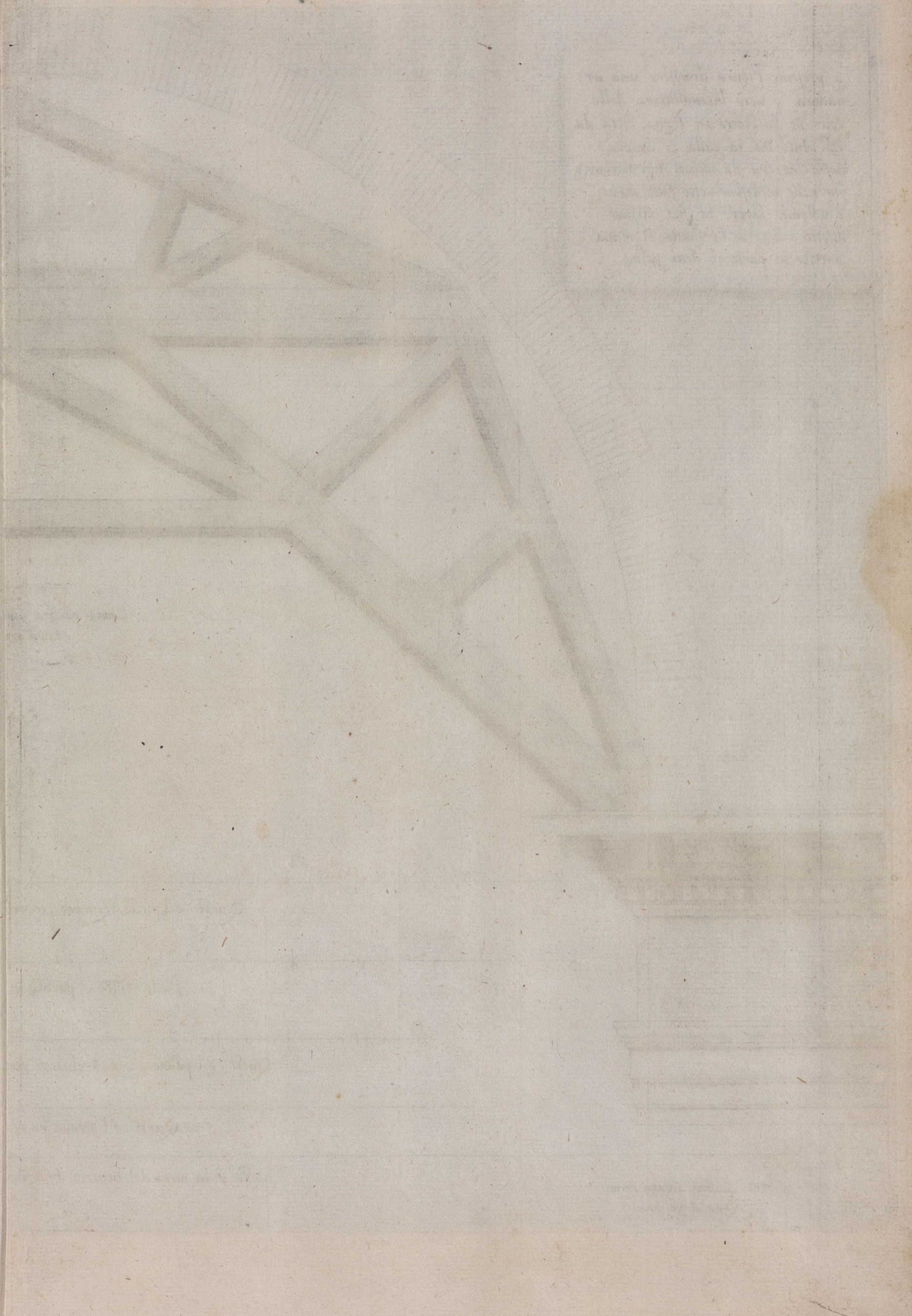

La presente Figura dimostra una armadura o uero Incauallatura delle volte Di S^a. Pietro Di Roma fatta da M^o. Ant^o. Da S^a. gallo T^a ancora messa Inopera da Michael Ang. Buonaroti pur nelle medesime volte fatte daluj. e uolendo sapere la sua misura disotto à detta ue la Canna Romana partito in parte .10. detti palmj.

Sara utile à qual si uoghia persona hauer messo nella presente Carta le misure antiche e moderne qual sono tolte da quelle stesse di campido: gliu seruono à architetti muratorj e falegnianj T^a mercanti et ad altri artieri ch^e esercitano le misure aparte: nenti alla loro perfezione.

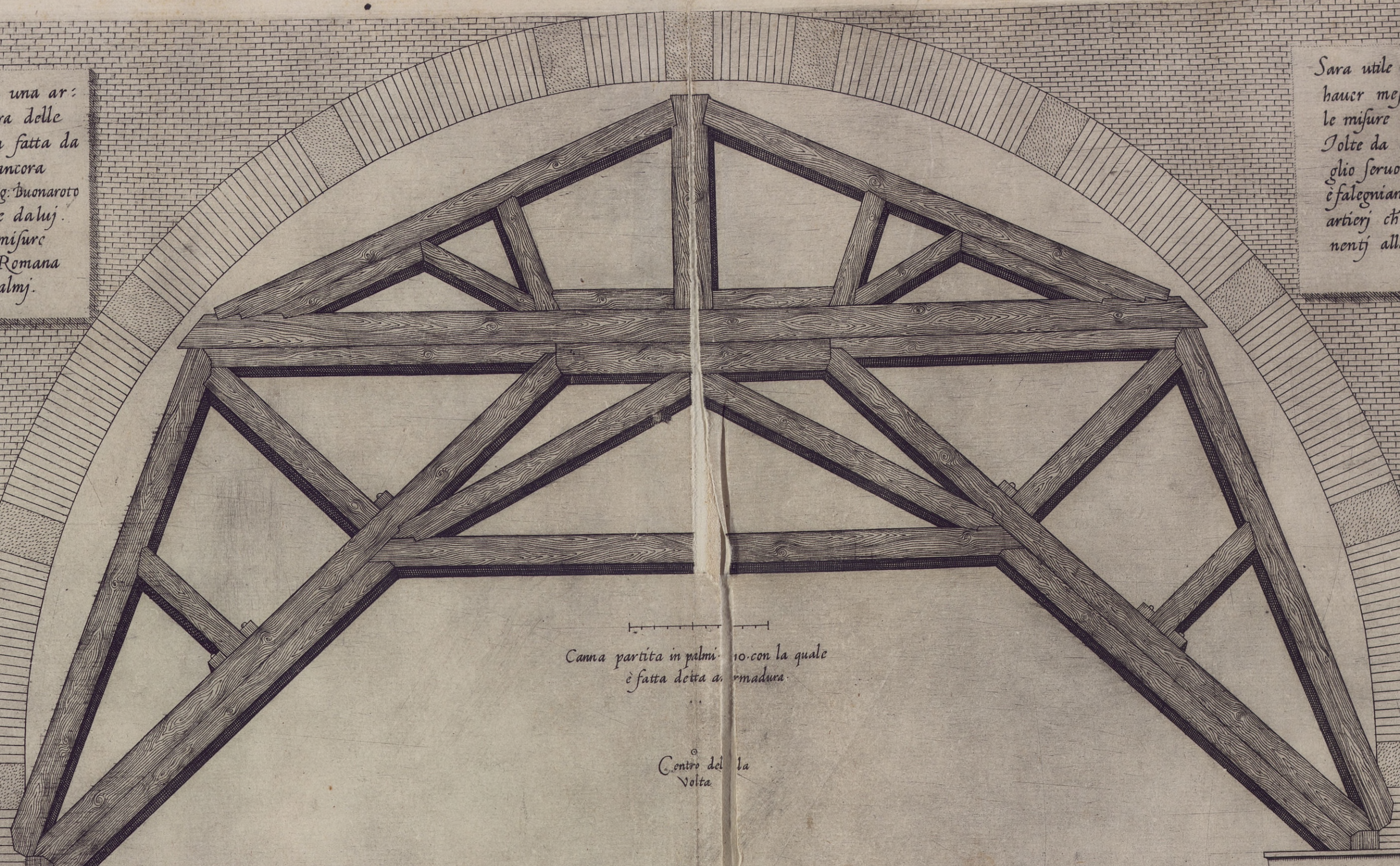

Canna partita in palmi .10. con la quale è fatta detta armadura.

Centro della Volta

Quest' è il piede Romano, partito in onci .12. T^a detti .16.

Piede Greco è partito in onci .12. T^a detti .16.

Quest' è il palmo degli Architetti partito in onci .12. T^a minuti .60.

Quest' è l'ottava parte della canna de' mercanti.

Quest' è la meta del braccio de' mercanti, partito in palmi quattro

Ant^o. Lafronj Sequanj Formis
Roma Anno .1561.

Jacobus Hostius Belgae, Summa delicia, circino excipit in aesp. incisit.

Faint, illegible text, possibly bleed-through from the reverse side of the page.

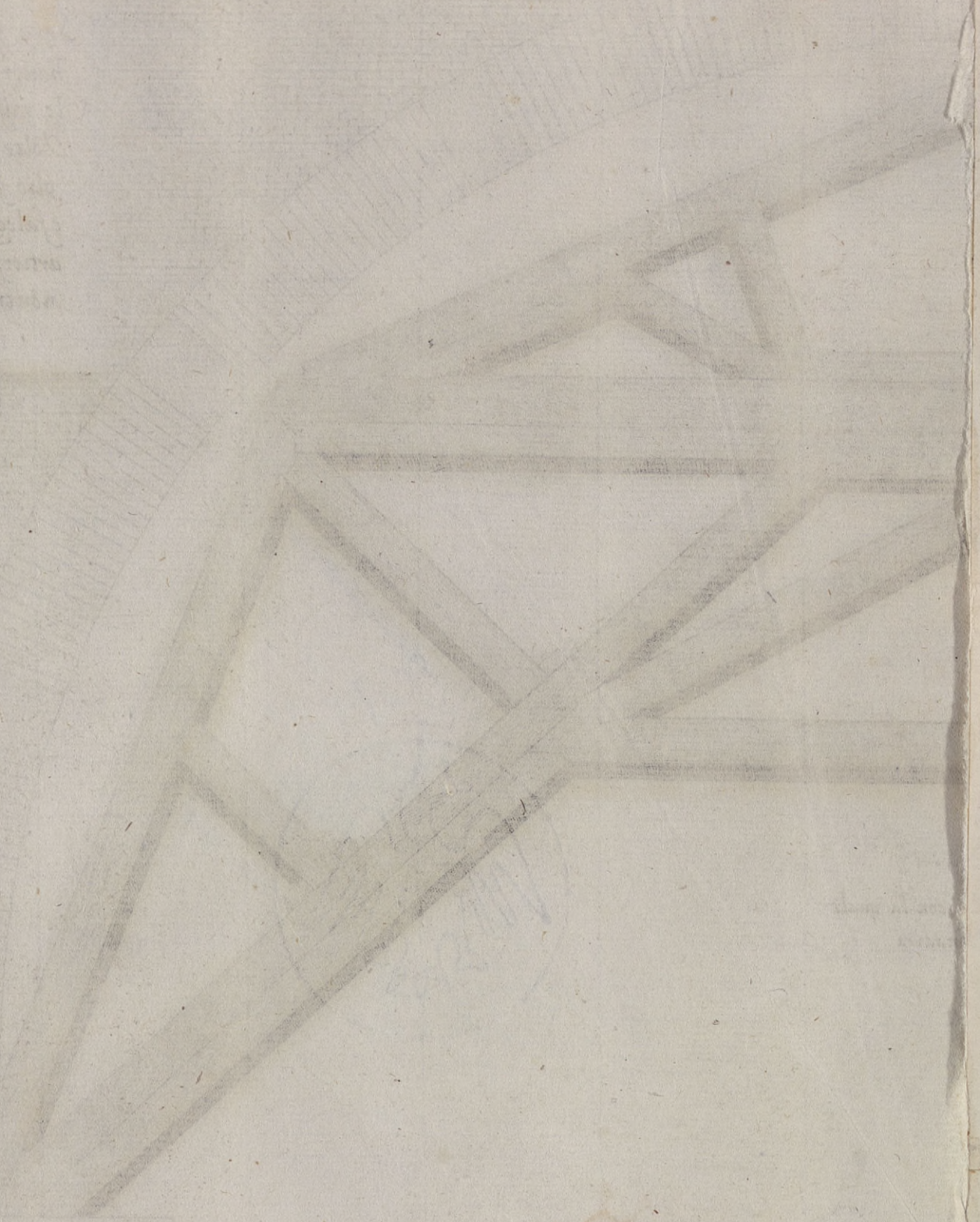



Faint, illegible text at the bottom left corner, possibly bleed-through from the reverse side of the page.

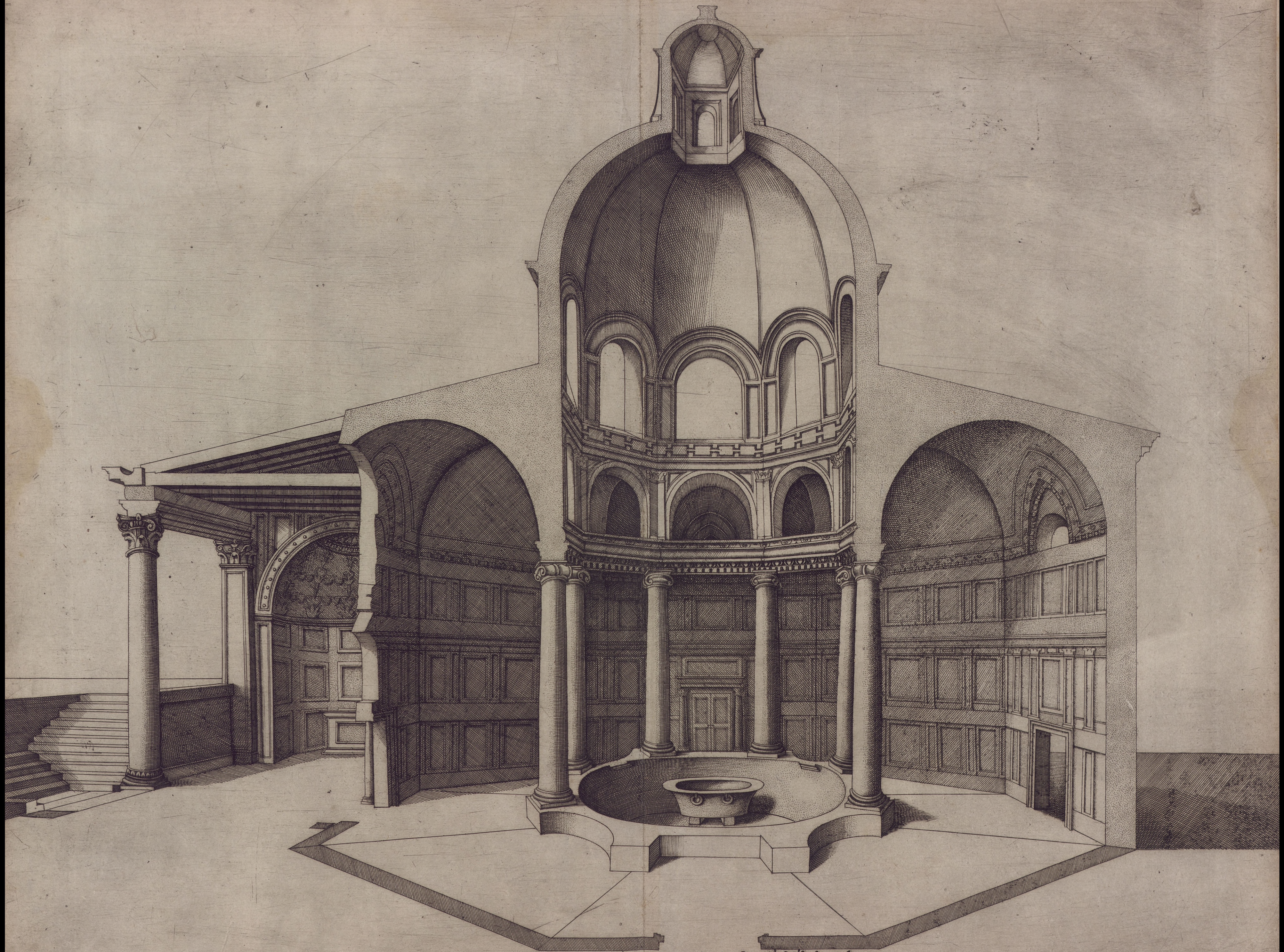

Balnei Laterani, & in eo, ad curandam Constant. Cæs. Elephantiæsim, in-
 noxio infantium sanguini suscipiendo primum parati Labri, ac mox conuer-
 sa in pietatem crudelitate, eiusdem baptismo destinati, simulacrum. Roma.

ANT. LAFRERI . EXC.



Extrait de l'ouvrage de M. de la Harpe

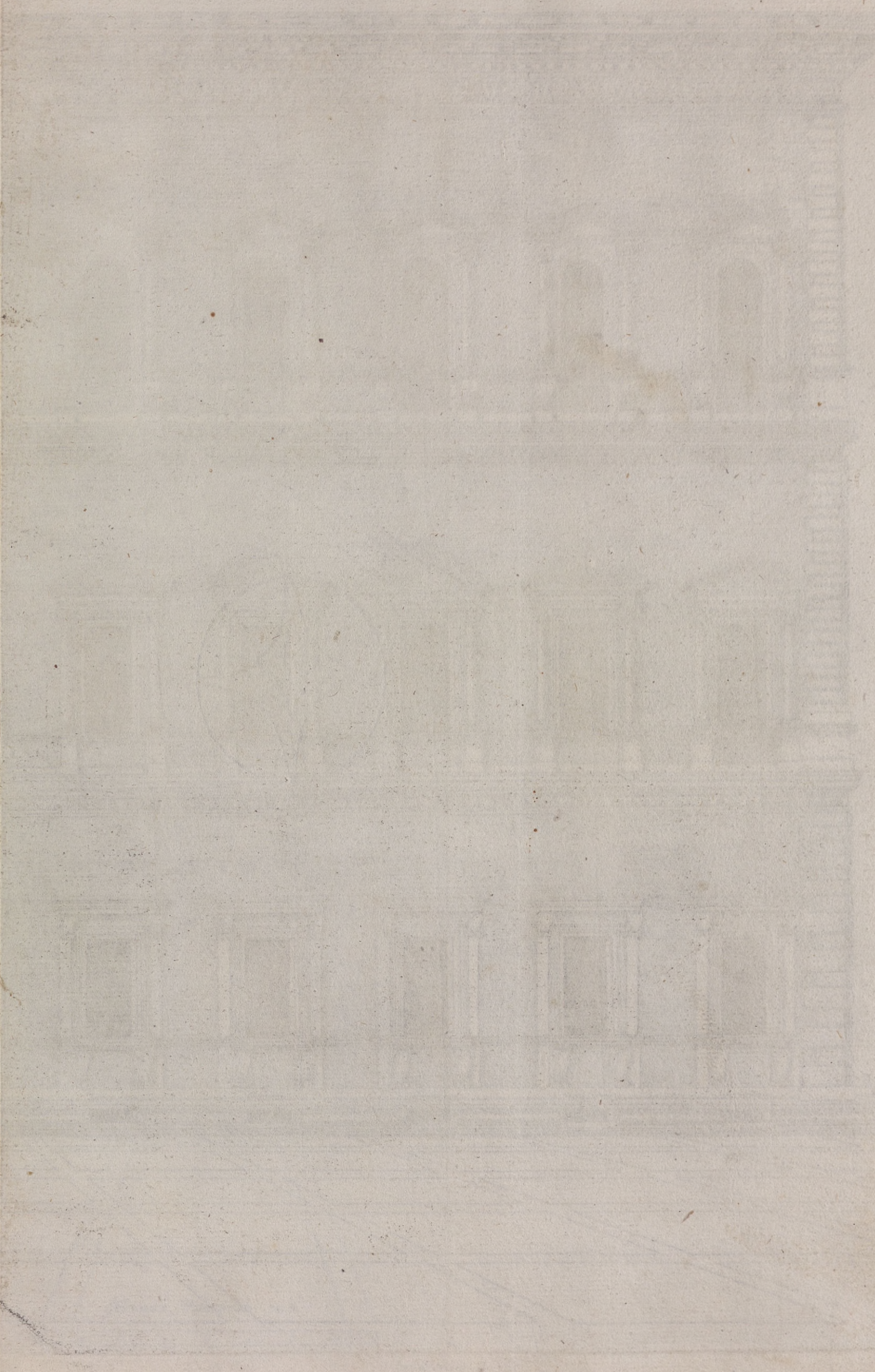

Exterior orthographia frontis Farnesiana domus: quam Roma, et magnis impensis, et servatis architecturae praeceptis PAVLVS Tertius Pontifex Maximus, à fundamentis memoria causa, sibi Posterisque suis crexit.

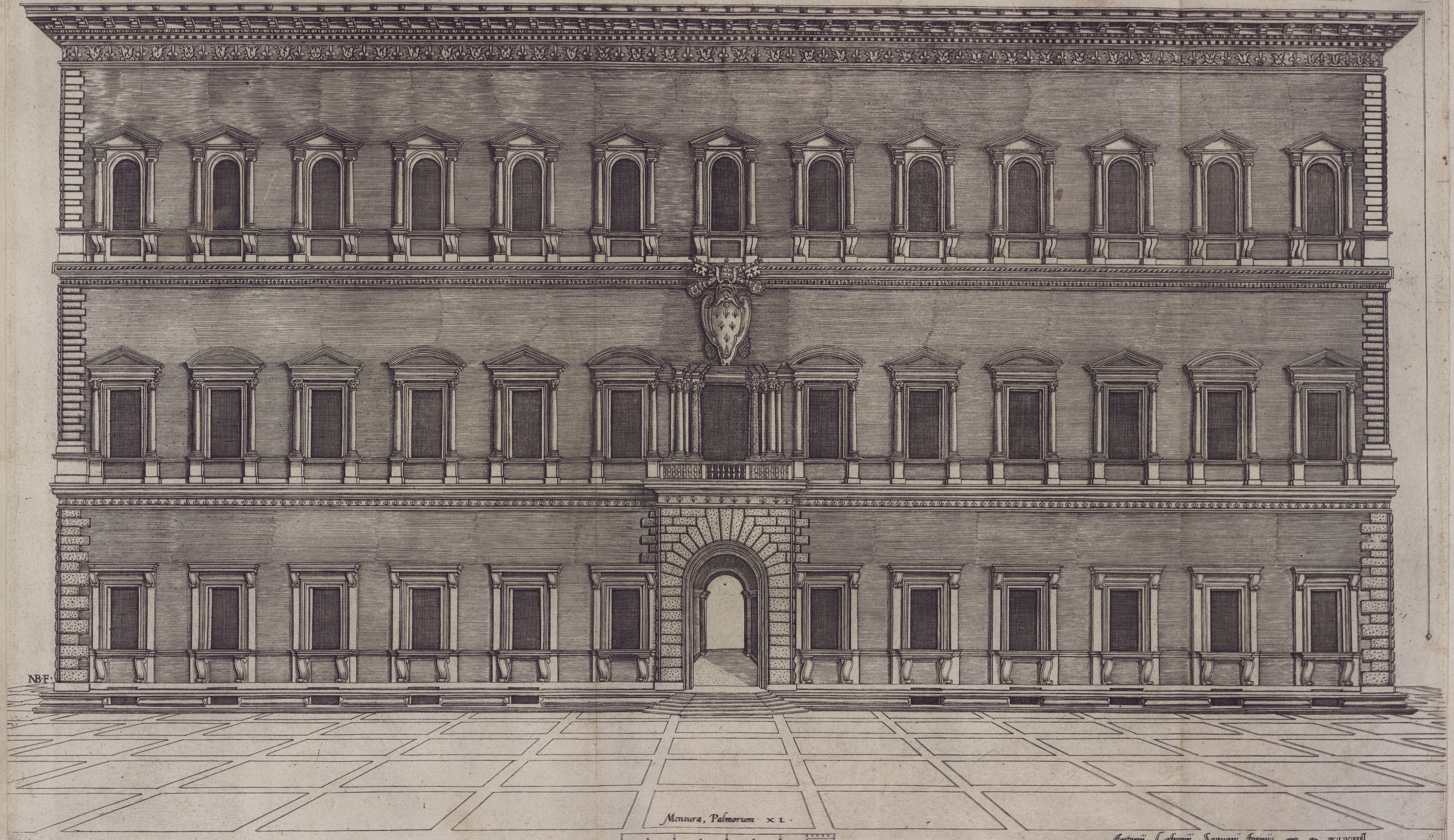

NBF

Mensura, Palmorum x 1.

Antonij Casparij Squani fomis 88 XLVIII





Raph. ...
 ...

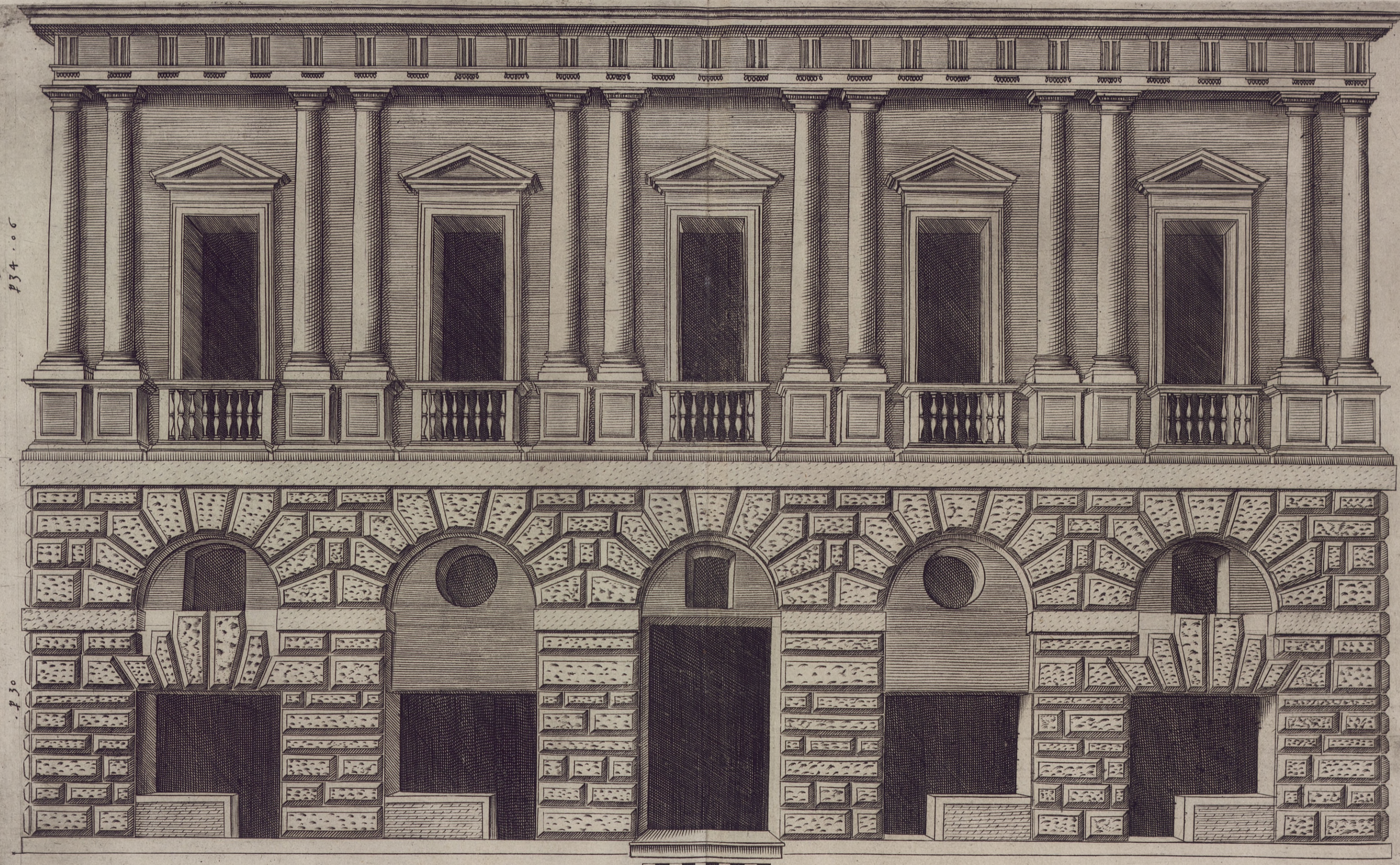

P. 34 . 06

P. 30

Raph. Vrbinat ex Lapide Coctili Roma, exstructum.
Antonij lastronj Roma 1549



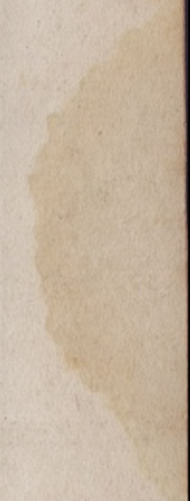

Faint, illegible text or markings at the bottom left of the page.

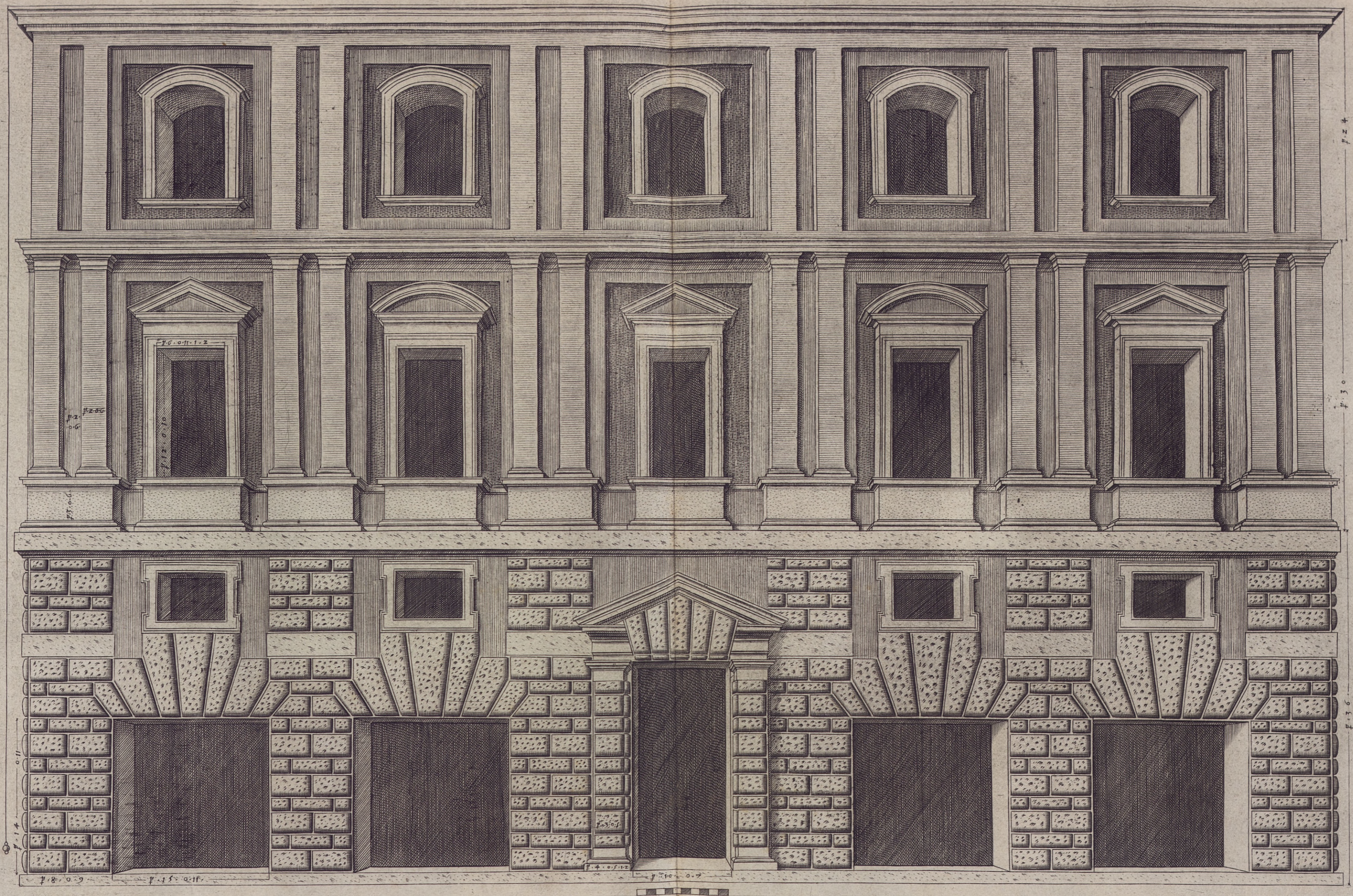

Palatium, Pauli Stacij e regione Divi Eustachij, ad veterum normam ac formam, Romæ, recens exstructum.

Antonij Laferij Romæ 1549

